

- Easy to Install and Expand
- Output to Interface with Local Refuge Outstation
- Integral PSU (13A Spur required)
- Braille on Reset Indicator
- Up to 4 Pull Cords on a System
- Complies with DDA Requirements

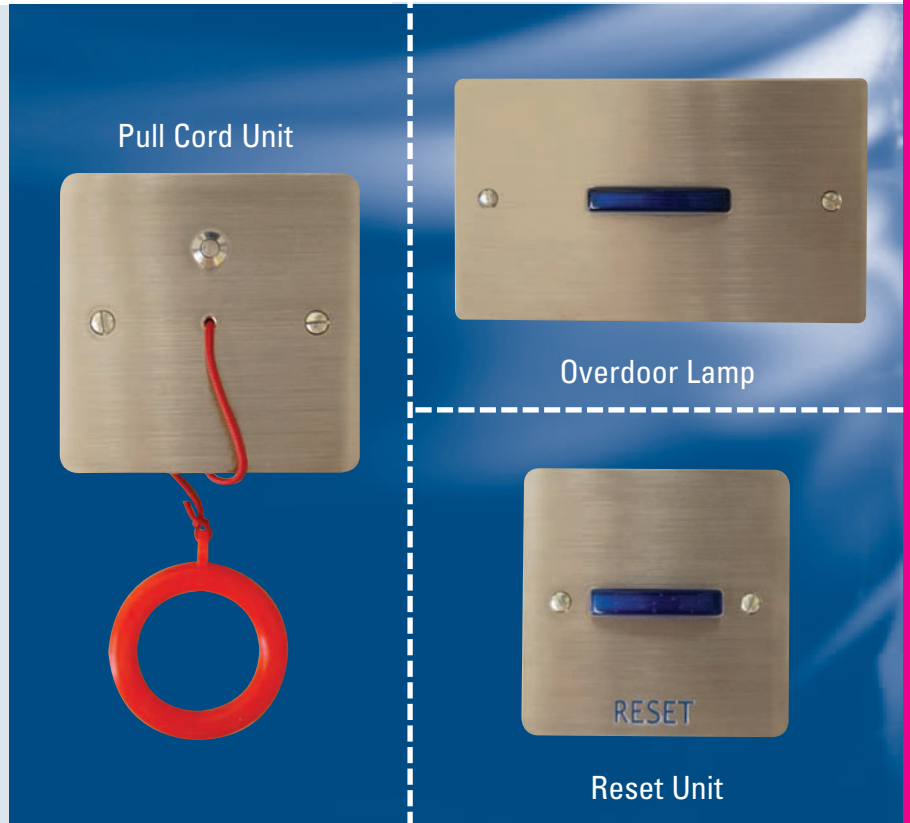

The Protec toilet call system has been designed to meet the latest DDA requirements, BS8300 and various other care standards. It is a very simple system to install and expand.

There are three parts to a typical kit, that fits standard electrical back boxes. Extra items can be ordered if expansion is required. This is a brushed stainless steel kit that requires plaster depth type back boxes providing a flush installation only, not surface.

Note: The Overdoor unit is two gang, whilst the Pull cord and Reset unit are single gang.

#### **Pull Cord Unit**

The pull cord unit is supplied with a red plastic ring. An extra ring is provided to conform to 'Approved Document M'. The second ring should be fitted lower down near floor level.

Activating a call is simply made by pulling the cord. This will activate the reassurance indicator on the pull cord unit. This will in turn illuminate the reset unit and trigger the internal sounder. At the same time the Overdoor indicator/sounder unit will illuminate and trigger its own internal sounder.

#### **Reset Unit**

The reset unit has a blue engraved legend 'RESET'.

When a call is activated the reset switch illuminates and the internal sounder activates. The call is reset by simply pressing the reset switch.

The reset switch is supplied with Braille legend on the switch piece.

#### **Overdoor Lamp / Sounder / PSU**

The Overdoor indicator/Sounder unit is supplied with an integral Power supply unit. A fused spur should be fitted nearby and wired to this unit to provide power.

As detailed above this unit will illuminate and sound as soon as a call is activated. The unit will cease once the reset switch is pressed.

# Technical Information

## Connection Diagram

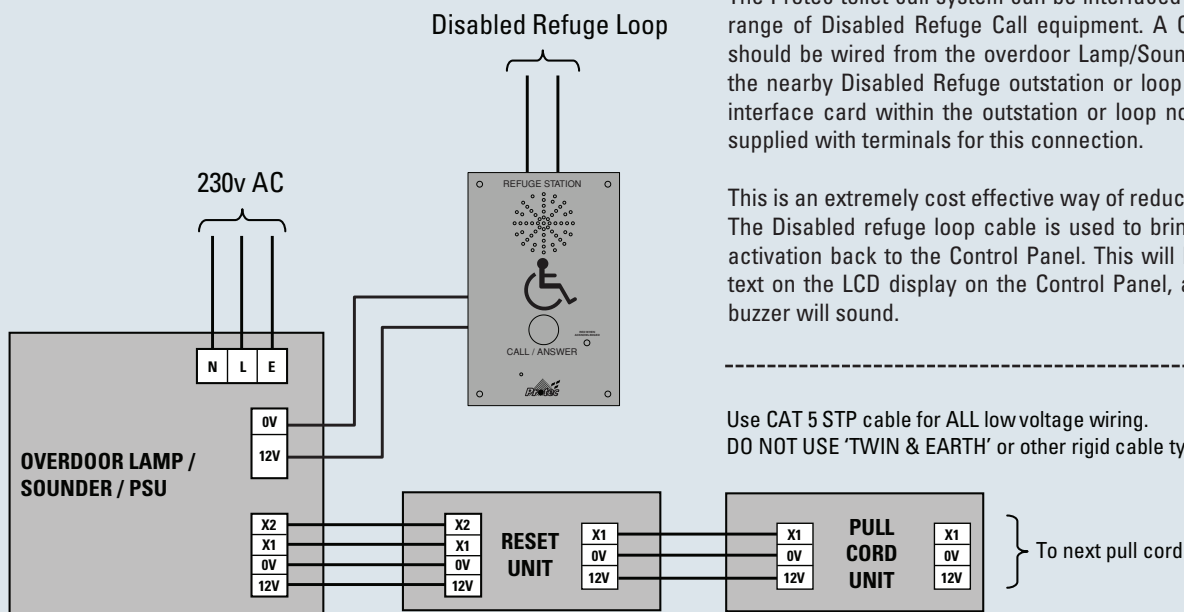

## Interfacing to a Disabled Refuge Call system

The Protec toilet call system can be interfaced with the Protec range of Disabled Refuge Call equipment. A CAT5 STP cable should be wired from the overdoor Lamp/Sounder/PSU unit to the nearby Disabled Refuge outstation or loop node. The loop interface card within the outstation or loop node back box is supplied with terminals for this connection.

This is an extremely cost effective way of reducing cable costs. The Disabled refuge loop cable is used to bring the toilet call activation back to the Control Panel. This will be displayed as text on the LCD display on the Control Panel, and the internal buzzer will sound.

Use CAT 5 STP cable for ALL low voltage wiring.  
DO NOT USE 'TWIN & EARTH' or other rigid cable types

## Typical Wiring Schematic

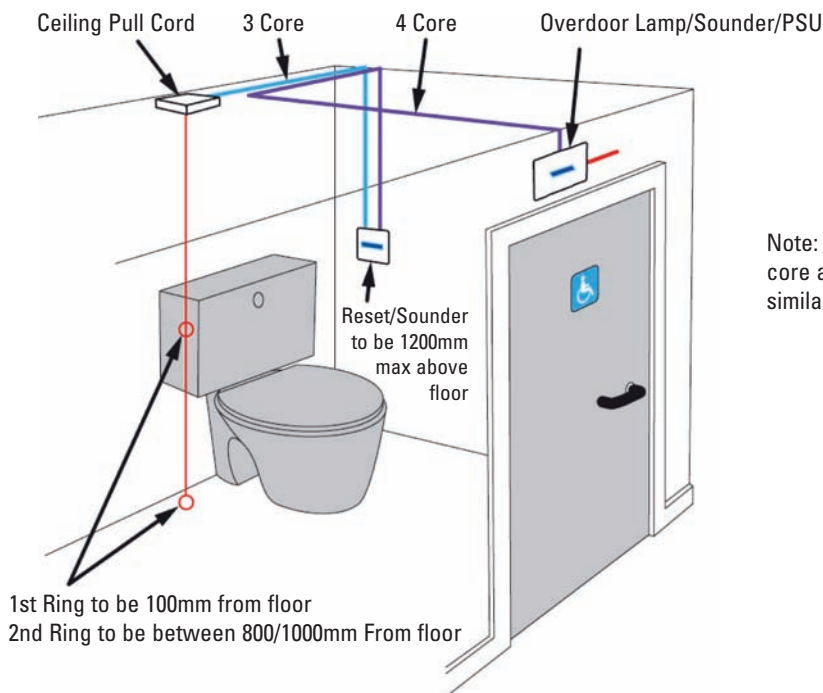

Note: CAT 5 STP type cable should be used for the 3 core and 4 core interlink wiring. Twin and Earth or similar rigid type cables should never be used.